

15th ANNUAL MORNINGSIDE DAY OUT KIDS' MARKET

Seller Information for the 2008 Kids' Market Sale!

Important Dates to Remember

Kids Market Merchandise Drop-off

Tuesday, February 5th, 2008

Drop off items 10:00am - 1:00pm and 4:00pm-7:00pm

Sale Dates

Thursday night, February 7th, 2008

Preview Sale 5:00pm - 7:00pm

Doors open to the public at 7:00pm - 9:00pm

Last admittance 8:15pm

For everyone's safety, No kids allowed.

Friday, February 8th, 2008

10:00 am - 1:00pm

For everyone's safety, No kids,
only infants in front pack carriers will be allowed.

Saturday, February 9th, 2008

$\frac{1}{2}$ Price Sale 9:00am - 1:00pm

Kids' Market Merchandise Pick-up

Saturday, February 9th, 2008

Pick up items 4:00 pm to 6:00 pm

MDO's 2008 Kids' Market Location

Morningside Day Out Kid's Market

is held at

Druid Hills United Methodist Church

1200 Ponce de Leon

At the corner of

Ponce de Leon Avenue and Briarcliff Road

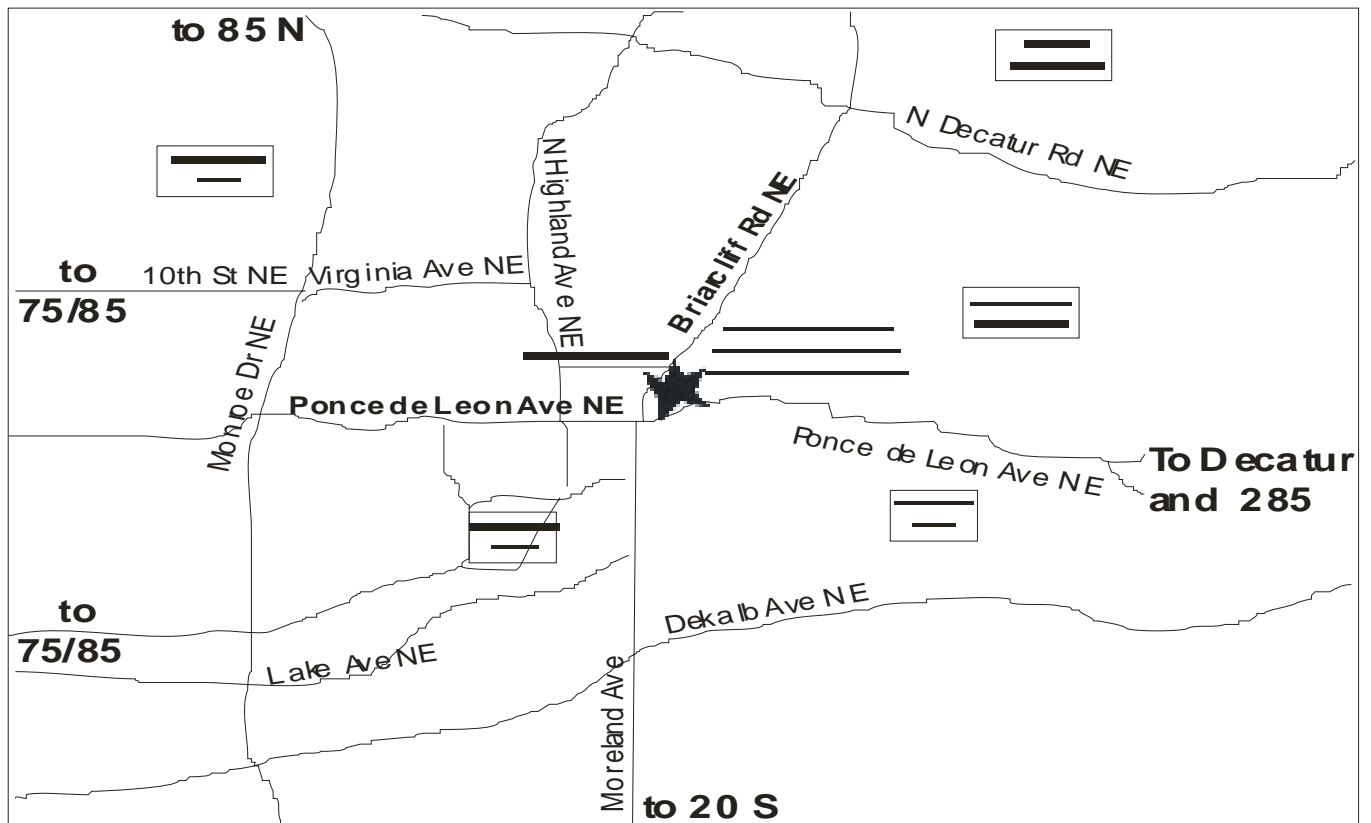

Seller Information

When do I drop off sale items?

Drop off is Tuesday, February, 5th, 10am to 1pm and 4pm to 7pm at Druid Hills United Methodist Church Fellowship Hall. You will receive a Preview Sale Pass and a Buddy Pass if you have \$50 in tagged merchandise or donations. Please allow enough time to unload your items, deliver them to the Fellowship Hall, have them inspected, then put them out onto the sales floor yourself. To expedite inspection and putting them out onto the racks, please presort all clothing first by gender, then by size.

When can I pick up unsold merchandise and checks?

Merchandise Pick up is Saturday, February 9th, 4pm to 6pm at Druid Hills United Methodist Church Fellowship Hall. Your unsold white tagged items will be collected for you to take. Checks will be mailed to all sellers beginning February 12th. Tax receipt for the donation portion will be available during merchandise pick-up Saturday, February 9th.

What items can be entered into the sale?

Children's clothing for ALL SEASONS, size newborn up to size 12; Maternity clothing (limit 15 items per seller); Children's shoes, socks, hats, gloves, accessories; Toys, games, puzzles, bath toys, outside toys, newborn toys, riding toys, bikes, scooters, skates; Strollers; High chairs; Bouncy seats; Exersaucers; Infant bath tubs; Car seats; Dining booster seats; Baby swings; Nursing and feeding equipment and supplies; Diaper bags; Safety equipment; Nursery décor; Cribs, changing tables, rocking chairs/gliders; Crib sheets; Baby towels; Monitors; Baby carriers; Pack-N-Plays; Books - children's and parenting books; Videos in original packaging; DVDs; CDs; Electronic game cartridges; Other items directly related to children and parenting.

Items must be clean and free from stains. Items must be in good repair. Only gently worn, very clean shoes will be accepted.

Clothes with holes, tears or stains will be rejected.

We do not accept stuffed animals or underwear.

Seller Information (continued)

How should merchandise be presented for sale?

Following these guidelines provides consistency and ease for the shoppers, good buzz about the sale and profit for you!

Price Tag Instructions:

- Use your **four-letter code** and **bar code** on every tag. We are using barcoded seller codes in addition to alphabetical codes to accurately credit your sales to you. When you print your tag template, you will see your code along with the barcode for your four digit seller code. On an exception basis, we will accept tags without barcodes (i.e. the items were tagged for another sale.)
- Tag items you want donated to MDO on blue card stock with the seller code MDOP, with or without a price. We will also accept untagged items as donations.
- Tags should be made of white card stock or heavy white paper and printed in dark ink.
- If you wish to donate unsold items to charity after the sale, tags should be made of blue card stock or heavy baby blue paper.
- Prices must be in increments of 25 cents. Minimum price for an item is 50 cents.
- Tags must not have cross-outs. This is to prevent cheating. If you make a mistake, re-do the tag.
- Write NO in the lower right corner, if you do NOT want the item sold at $\frac{1}{2}$ price on Friday evening. The word NO can only be written on white tags, as all blue tags will go to half price before being donated.
- Items without tags, seller codes and/or prices will not be sold.
- More detailed descriptions on the tag are encouraged, i.e. "entire outfit", "used twice", "runs big", "new batteries", "blue four way pack-n-play".

Seller Information (continued)

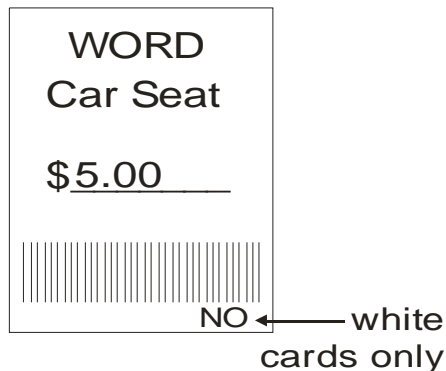

Hanging instructions for clothing:

- **Garments must be on hangers.** We prefer wire drycleaning hangers without cardboard bars. These hangers slide easier on the racks and compress more neatly. Wire hangers with paper covering are easy to safety pin smaller items to. Many drycleaners offer these hangers for free. Please do not bend wire hangers.
- **All hanger openings should face left as you view the front of the garment.** See illustration below.
- **Use silver safety pins to ensure tags stay attached. No straight pins or tiny gold safety pins!**
- The tag should be securely attached to the item's left side on the front of the garment, opposite the side of the hanger opening for shoppers to view on the rack. See illustration below.
- Multiple-piece outfits go on one hanger. Entire outfits sell better than separates. Each piece must be the same size. Pin hats or socks securely to the outfit's top with safety pins. On the tag, write the number of pieces in the outfit.
- Multiple items of the same size may be pinned together on one hanger and sold for one price, i.e. 3 pairs of girls' size 24 mo. pants for \$5.00.
- For clothing, indicate "boys" or "girls" and the size on your tag. If the item could be either boys or girls, it may sell better as a boy item.
- If the garment indicates size by weight, convert to the appropriate size as follows:
 - Up to 12 lbs = 0-3 months; 12-18 lbs = 6 months;
 - 18-22 lbs = 9 months; 22-26 lbs = 12 months;
 - 26-29 lbs = 18 months and 29-32 lbs = 24 months.
- Please sort clothing first by gender, then by size to make your drop-off quicker.

Seller Information (continued)

WHITE TAGS
IF YOU PLAN TO PICK UP
BLUE TAGS
IF YOU PLAN TO DONATE



For Other Items:

- Big ticket items should have tags taped **and** pinned to secure them firmly. If an item loses its tag, it cannot be sold.
- Books, tapes and games should have the tag taped securely to the front or back cover. Videos must be in their original box.
- Items with multiple small pieces should be placed in a clear plastic bag and securely closed with tape.
- Large toys and accessories should have any removable parts sealed in a clear plastic bag.
- Items with multiple pieces should have each piece tagged. For example, if a high chair has three pieces, it should have a tag with your seller code on each piece indicating 1 of 3, 2 of 3, 3 of 3.
- Wrap puzzles with Saran Wrap or put in a ziplock bag. Do not use tape on the face of the puzzle, it ruins the pieces.
- Further secure plastic bags with clear tape over the opening.
- **Shoes should be secured together and placed inside a sealed plastic bag. Please attach shoes using straps or twist ties. The price and size of the shoes should be written on the outside of the bag and also attached to the shoes on the inside of the bag. The only exception is for boots which are too large to fit inside plastic bags. Please tie boots together as best as possible.**

Remember:

- Blue tags for items to be donated and white tags for items to be picked up after the sale.
- Half price items are more likely to sell.
- Price your items wisely, keeping in mind what you would pay for the item at a consignment sale.

- Only GENTLY worn clothing and shoes with no tears or stains will be accepted at inspection on Seller Drop-Off day.

Morningside Day Out
P.O. Box 8986 Atlanta, Georgia 31106
tel. 404-634-5889 fax 404-634-5819